



**DEPOT PARK**  
SACRAMENTO'S SECURE BUSINESS CAMPUS

OWNED BY:



**FOR LEASE**

**Building  
348**



**Siena Avenue, Sacramento CA**

**±2,415 SF up to 6,480 SF**

**Available**

- Warehouse space
- Sprinklered
- Dock & Grade Loading
- Abundant parking
- On-site fueling station for your fleet
- Depot Park is a fully secured business Park with enclosed perimeter, gated entry points and round-the-clock security patrol

For more information, please contact:

**DAVID NICHOLSON**

Director

**+1 916 288 4422**

david.nicholson@cushwake.com

CA License #01845338

**BRYCE MACDONALD**

Senior Director

**+1 916 288 4806**

bryce.macdonald@cushwake.com

CA License #01422174

**MATT COLOGNA, SIOR**

Senior Director

**+1 916 288 4805**

matt.cologna@cushwake.com

CA License #01210309



[depotpark.com](http://depotpark.com)



**DEPOT PARK**  
SACRAMENTO'S SECURE BUSINESS CAMPUS

OWNED BY:



**FOR LEASE**

# Siena Avenue, Sacramento CA

**Building 348**

**±2,415 SF up to 6,480 SF**

Available

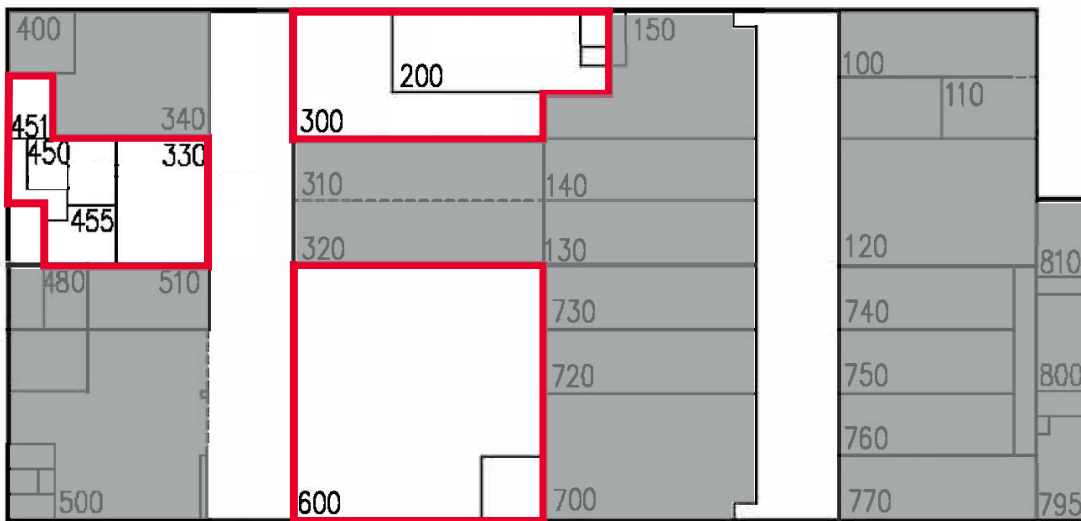

Suite	Total SF	Warehouse SF	Office SF
200-300	±3,843	±2,124	±1,719
330-455	±2,415	±1,200	1,215
600	±6,480	±6,080	±400



[depotpark.com](http://depotpark.com)

For more information, please contact:

**DAVID NICHOLSON**  
Director  
**+1 916 288 4422**

david.nicholson@cushwake.com  
CA License #01845338

**BRYCE MACDONALD**  
Senior Director  
**+1 916 288 4806**

bryce.macdonald@cushwake.com  
CA License #01422174

**MATT COLOGNA, SIOR**  
Senior Director  
**+1 916 288 4805**

matt.cologna@cushwake.com  
CA License #01210309